

NOTES:

1. INDIVIDUAL COMPONENTS ARE CALLED OUT FOR REFERENCE ONLY. MOST COMPONENTS ARE NOT AVAILABLE INDIVIDUALLY FOR PURCHASE. REFER TO OVERHAUL/REPAIR KITS TABLE (DRAWING NO 7033) FOR SERVICE KITS.
2. PRE ASSEMBLY REQ. IAW DIVE LAB QA MANUAL, DOCUMENT (XLDSPROOF22111 1B MW), MANUFACTURING REQUIREMENTS DWG# 7737

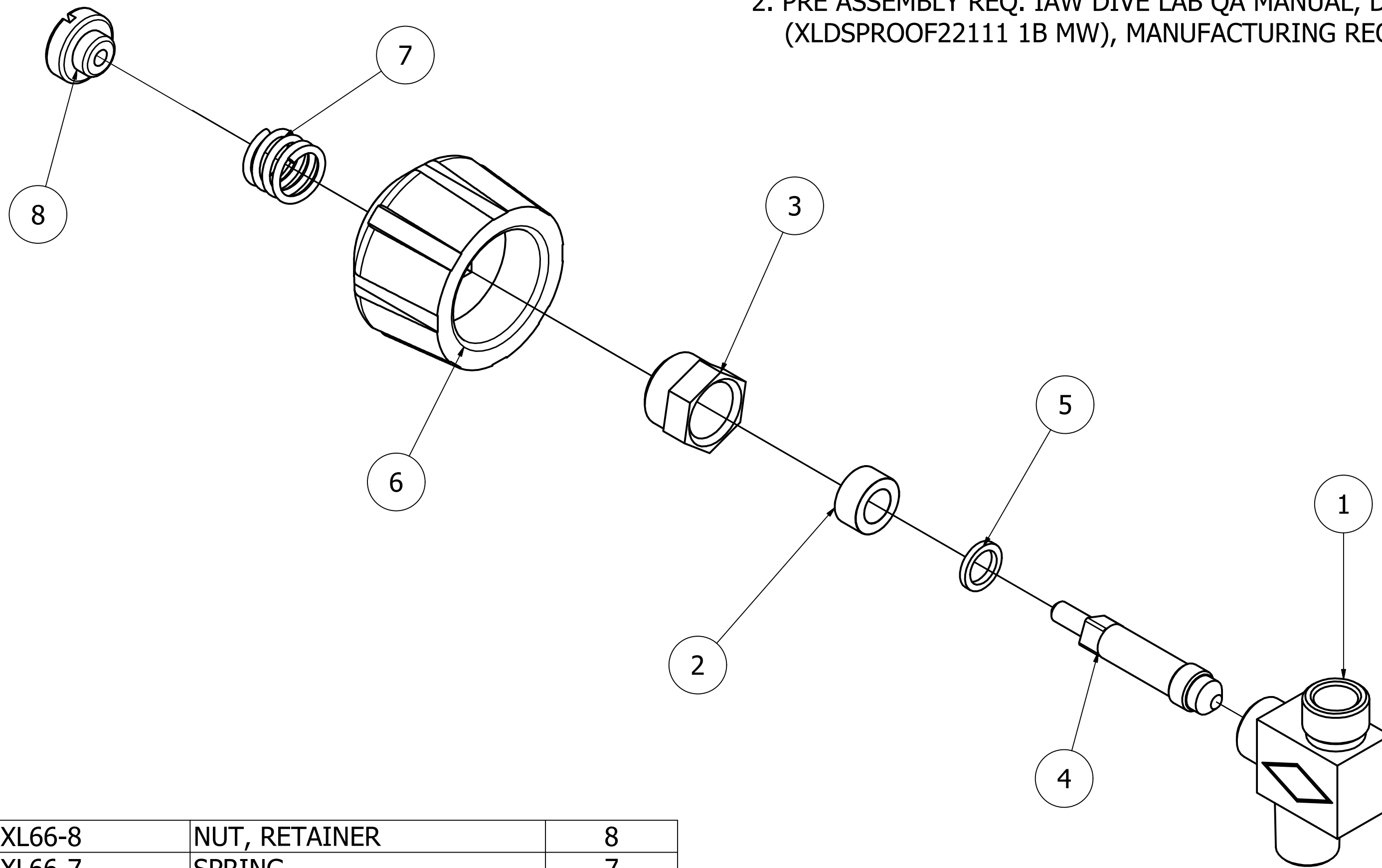

1	4XL66-8	NUT, RETAINER	8
1	4XL66-7	SPRING	7
1	4XL66-6	KNOB	6
1	4XL66-5	WASHER, BRASS	5
1	4XL66-4	STEM	4
1	4XL66-3	NUT, PACKING	3
1	4XL66-2	PACKING	2
1	4XL66-1	BODY	1
QTY	DIVE LAB PART	DESCRIPTION	ITEM
AUXILLARY GAS VALVE 4XL66			

MATERIAL	DIVE LAB INC. 1415 MOYLAN ROAD, PANAMA CITY BEACH, FL 32407 VOICE: 850-235-2715 FAX: 850-235-0858
	.X+- .032 .XX +- .01 .XXX +- .005 √63 UNSPECIFIED SURFACES
COPYRIGHT 2012 DIVE LAB INC.	

DRAWN MIKE S. WARD	5/6/2005	Dive Lab Inc.	
CHECKED R.H. QA	1/12/2012		
MFG		EMERGENCY GAS VALVE (EGS)	
APPROVED M.F. WARD	1/12/2012	SIZE C	DWG NO 7022
		SCALE	REV -
		SHEET 1 OF 1	