

NOTES:

1. INDIVIDUAL COMPONENTS ARE CALLED OUT FOR REFERENCE ONLY. MOST COMPONENTS ARE NOT AVAILABLE INDIVIDUALLY FOR PURCHASE. REFER TO OVERHAUL/REPAIR KITS TABLE (DRAWING NO 7033) FOR SERVICE KITS.
2. PRE ASSEMBLY REQ. IAW DIVE LAB QA MANUAL, DOCUMENT (XLDSPROOF22111 1B MW), MANUFACTURING REQUIREMENTS DWG# 7737

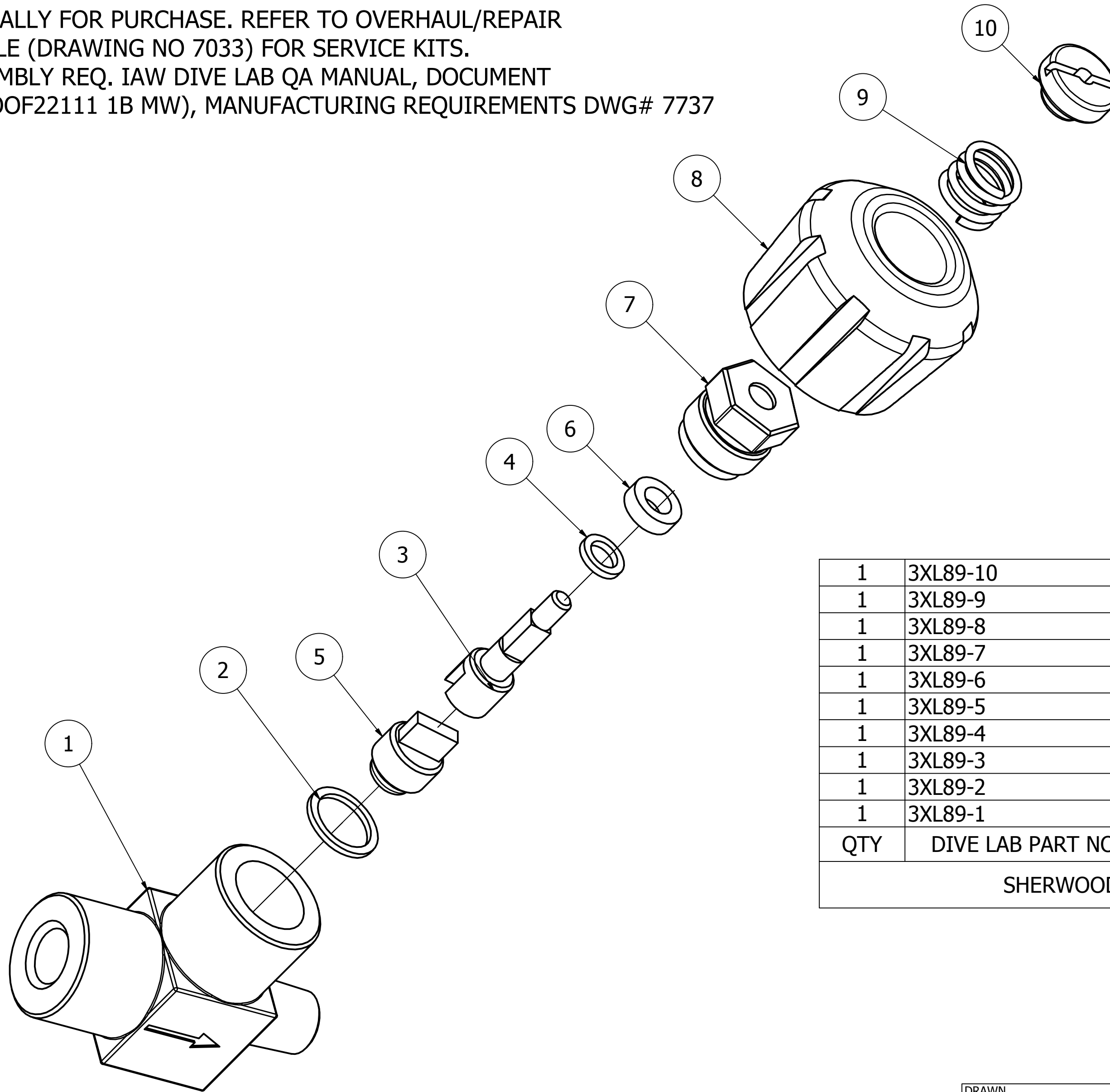

1	3XL89-10	LOCK NUT	10
1	3XL89-9	SPRING	9
1	3XL89-8	KNOB	8
1	3XL89-7	PACKING NUT	7
1	3XL89-6	PACKING	6
1	3XL89-5	SEAT	5
1	3XL89-4	WASHER	4
1	3XL89-3	STEM	3
1	3XL89-2	WASHER, COPPER	2
1	3XL89-1	BODY	1
QTY	DIVE LAB PART NO	DESCRIPTION	ITEM
SHERWOOD HP VALVE 3XL89			

MATERIAL	DIVE LAB INC. 1415 MOYLAN ROAD, PANAMA CITY BEACH, FL 32407 VOICE: 850-235-2715 FAX: 850-235-0858
	.X+- .032 .XX +- .01 .XXX +- .005 √63 UNSPECIFIED SURFACES
COPYRIGHT 2012 DIVE LAB INC.	

DRAWN M.S. WARD	5/18/2005	<b>Dive Lab Inc.</b> <b>SHERWOOD VALVE</b> <b>HIGH PRESSURE</b>		
CHECKED R.H.	1/16/2012			
QA				
MFG		SIZE C	DWG NO 7010	REV -
APPROVED M.F. WARD	1/16/2012	SCALE	SHEET 1 OF 1	