

NOTES:

1. PRE ASSEMBLY REQ. IAW DIVE LAB QA MANUAL, DOCUMENT (XLDSPROOF22111 1B MW), MANUFACTURING REQUIREMENTS DWG# 7737

2. SOME ITEMS HAVE OPTIONS AVAILABLE. SEE TABLE TO DETERMINE CORRECT PART FOR YOUR SYSTEM
 3. STANDARD HOSE CONFIGURATION, ZCO HOSE END FITTING IS SWAGED ONTO HOSE 1/4 MNPT x 9/16-18 UNC. H.P. HOSE WITH 1/4 MNPT END IS ALSO AVAILABLE.

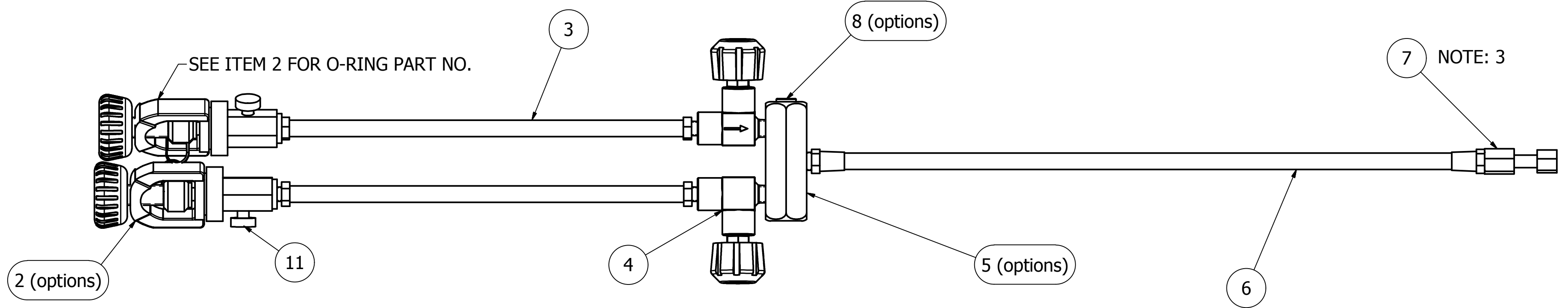

-	3XL29E 3XL29F	A YOKE & DIN YOKE BLEED KNOB (FOR XS SCUBA YOKES) A YOKE BLEED KNOB (FOR SHERWOOD A YOKES)	11
1	3XL43	IN USE TAG COMPLETE	
-	3XL42	IN USE TAG PLATE (ABS PLASTIC)	10
-	3XL41	DECAL, IN USE	
1ea	3XL40R 3XL40G 3XL40Y	DECAL, AHP-1 RED DECAL, AHP-2 GREEN DECAL, AHP-3 YELLOW	9
1	1XL15CB	PLUG HIGH PRESSURE 7/16-20 UNF	
1	3XL90	-012 O-RING 90 DUROMETER, VITON (OPTIONAL 1/4" MNPT PLUG 1XL15B)	8
1	3XL100	FITTING, .25 MNPT - 9/16-18 UNF ZCO	7
1	3XL87	HIGH PRESSURE WHIP, S.S. BRAIDED 72" 1/4 MNPT x ZCO 9/16-18 UNF	6
1	3XL25	HIGH PRESSURE JUNCTION BLOCK, SINGLE PORT, 7/16-20 UNF ST O-RING PORT (STANDARD)	5
1	3XL25-2 3XL25-1	HIGH PRESSURE JUNCTION BLOCK, DOUBLE PORT 1/4" MNPT HIGH PRESSURE JUNCTION BLOCK, DOUBLE PORT 1/2-20 UNF	5
2	3XL89	HIGH PRESSURE VALVE, SHERWOOD 1/4 MNPT	4
2	3XL26	HIGH PRESSURE WHIP, S.S. BRAIDED 12" 1/4 MNPT	3
2	3XL29D	DIN-YOKE ADAPTER MAX PRESSURE 4350 PSIG (STANDARD) - DIN-YOKE O-RING -112 90D VITON, DIVE LAB PART NO. 6XL9	2
-	3XL29 3XL90	A YOKE 3500 PSIG (OPTIONAL) DUST CAP (FITS DIN & A YOKE)	2
-	1XL00 R,G,Y	HIGH PRESSURE, SINGLE LEG ASSEMBLY R,G,Y	1
QTY.	DIVE LAB PART NO.	DESCRIPTION	ITEM NO
		HIGH PRESSURE ASSEMBLY (SINGLE LEG R,G,Y) 1XL00	

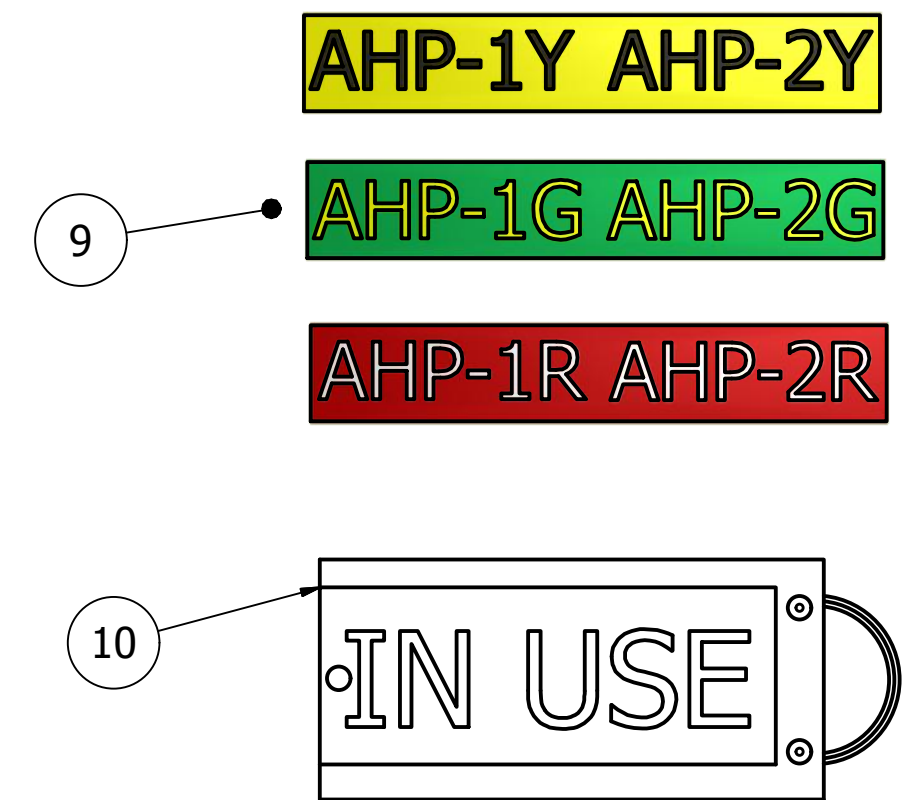

MATERIAL: DIVE LAB INC. 1415 MOYLAN ROAD, PANAMA CITY BEACH, FL 32407
 VOICE: 850-235-2715 FAX: 850-235-0858
 .X+- .032 .XX +- .01 .XXX +- .005 ✓63 UNSPECIFIED SURFACES

DRAWN: M.S. WARD 6/14/2007
 CHECKED: R.H. 1/12/2012
 QA: MFG:
 APPROVED: M.F. WARD 1/12/2012

Dive Lab Inc.
 TITLE: HIGH PRESSURE ASSEMBLY
 SIZE: C DWG NO: 7009 REV: -
 SCALE: SHEET 1 OF 1